

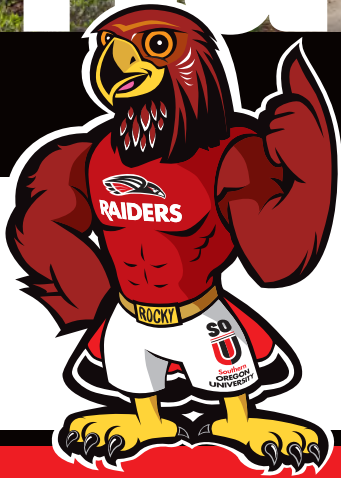

hawk walk



self-guided
campus tour



SO | Southern **OREGON**
U | **UNIVERSITY**





Welcome to Southern Oregon University!

This self-guided tour packet will help you explore our university. Starting from any point on campus, this guide will take you to academic buildings, our student union, dining facility, residence halls, and other campus landmarks.

Admissions counselors are available to answer questions on a drop-in basis during business hours, Monday through Friday, 9 am to 5 pm.

For additional inquiries, please feel free to contact us:

Office of Admissions
1250 Siskiyou Boulevard
Ashland, Oregon 97520

541-552-6411 (local)

855-470-3377 (toll free)

admissions@sou.edu

sou.edu/admissions

We hope you enjoy your visit to our beautiful campus!

Campus Art Installations

With each state-funded capital improvement project on campus, SOU sets aside a percentage of the budget for public art that reflects the spirit of the SOU community. We have highlighted these installations throughout the booklet so you can view them on your Hawk Walk.



1. Office of Admissions Welcome Center

The SOU Admissions office offers guided tours and hosts campus preview events. A staff of Admissions Counselors are available to meet with students and families. Prospective students can also apply on the spot to SOU using our kiosk computer stations in the lobby.

Admissions shares space with Disability Resources and the University Coaching and Mentoring (UCAM) program. Disability Resources serves any student needing accommodations in the classroom. UCAM is a fee-for-service program that helps students with executive functioning skills through professional coaching sessions.



Campus Art Installations

THIRD EYE THEATER

Spanning the lawn area between the Stevenson Union and Britt Hall, this installation is enjoyed by students and visitors alike. The various heights of stone make for a visually pleasing art piece, along with a great sitting area.

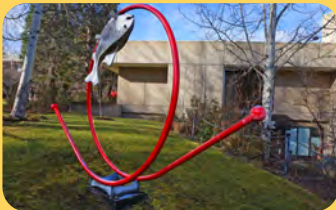

Campus Art Installations

WILD RUN!

Michael Zapponi's *Wild Run!* is a curved stainless steel bar with ends that extend from either side. The sculpture rests on a curved platform that is bolted to a concrete footing. Hanging upside down from the round bar is a large salmon fish.



2. Stevenson Union ("SU")

Named after former SOU President, Elmo Stevenson, the Stevenson Union (SU) is the center of student activity on campus, with spaces for student use, dining, and the Bookstore. Dining includes Elmo's food court and Einstein Bros. Bagel. The Social Justice and Equity Center (SJEC) is located on the top floor, providing inclusive spaces for students. The SU is also home to meeting and event spaces, student government (ASSOU), Student Life offices, and International Programs.



3. Education and Psychology Building

The hub for two of our most popular majors, this building also houses the Community Preschool at SOU. Early Childhood Development and Education Studies majors have the opportunity to earn practicum hours at the preschool while providing on-site care for students and community members with children.



4. Music Building

Music department offices and private practice rooms are located within this building, along with a nationally-acclaimed acoustic recital hall where performances and events are held for SOU and the Ashland community throughout the year.



5. Theatre Building

Newly renovated, the SOU Theatre building contains Theatre department offices and classrooms, a fully equipped scenery and costume shop, the Dorothy Stolp open stage theatre, and the black box theatre. As part of the Oregon Center for the Arts, SOU Theatre presents several performances each year. The renovated space includes a new, state-of-the-art studio for Jefferson Public Radio, an on-campus affiliate of National Public Radio that reaches listeners in southern Oregon and northern California.



6. Taylor Hall

Taylor Hall houses program offices and classrooms for the Social Sciences including Criminology and Criminal Justice; Economics; Gender, Sexuality & Women's Studies; History and Political Science; Native American Studies; and Sociology and Anthropology.



7. Computer Science Complex

The Computer Science Complex is separated into east and west buildings. In Computing Services East, you will find Raider Student Services and Computer Science classrooms. The IT help desk and media check-out area are located in Computer Services West along with program offices for Computer Science, University Seminar and Undergraduate Studies.



8. Science Building

The Science building holds program offices, lecture halls, and lab classrooms for the following academic majors: Biology, Chemistry, Mathematics, Environmental Science & Policy, and Sustainability. With the largest lecture hall on campus, seating is available for classes with 100-140 students. Lab courses break down from the lecture into groups of 25 students, allowing for one on one interaction with faculty and peers.



9. Hannon Library

Hannon Library has numerous computer labs and over 300,000 publications. EDsmart.com ranked the Hannon Library #20 on their list of "Incredible Libraries". Special resources also include a 9,000-volume Margery Bailey Collection of Shakespeare and English Renaissance materials. Free tutoring is available for math, science and writing through the Learning Commons on the first floor of the library. Media and textbook check-out is also available, along with the opportunity to reserve study rooms. For fun (and good luck), you may find the rare Swamphorse inside.



10. Britt Hall

Britt Hall is home to the classrooms and faculty of the Business, English and Communications departments. In addition, Oregon Health and Science University (OHSU) has nursing and simulation labs on the first floor.



Campus Art Installations

ARMILLARY SUNDIAL

An armillary sundial represents both the terrestrial globe and the celestial sphere using interlocking rings with a fixed rod through the center. This bronze sculpture by Vincent Oredson was installed on campus in 1987.



Campus Art Installations

RESONANCE AND DISPERSION

A 28-foot colorful ceramic mosaic welcomes visitors in the entrance rotunda of the Hannon Library. Designed by two Americans in their workshop in Italy, the design is composed of traditional marble and glass tiles.



Campus Art Installations

SWAMPY

Designed in 2009 by SOU alumna Trisha Johansen, Swampy combines digital art, sculpture, and biology. Swampy has since become SOU's very own 500 lb mythical hybrid creature.

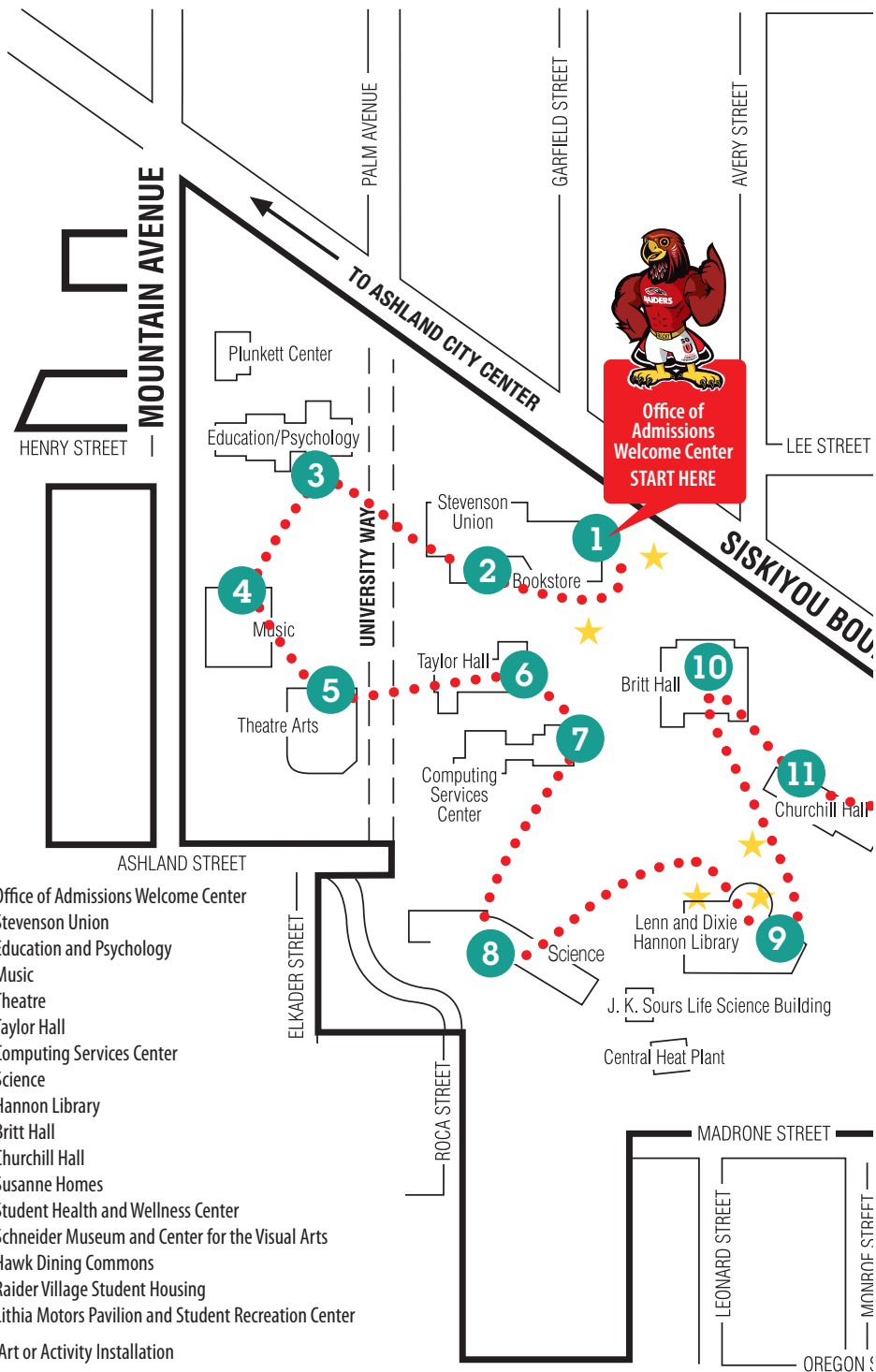

- 1) Office of Admissions Welcome Center
 - 2) Stevenson Union
 - 3) Education and Psychology
 - 4) Music
 - 5) Theatre
 - 6) Taylor Hall
 - 7) Computing Services Center
 - 8) Science
 - 9) Hannon Library
 - 10) Britt Hall
 - 11) Churchill Hall
 - 12) Susanne Homes
 - 13) Student Health and Wellness Center
 - 14) Schneider Museum and Center for the Visual Arts
 - 15) Hawk Dining Commons
 - 16) Raider Village Student Housing
 - 17) Lithia Motors Pavilion and Student Recreation Center
- ★ = Art or Activity Installation



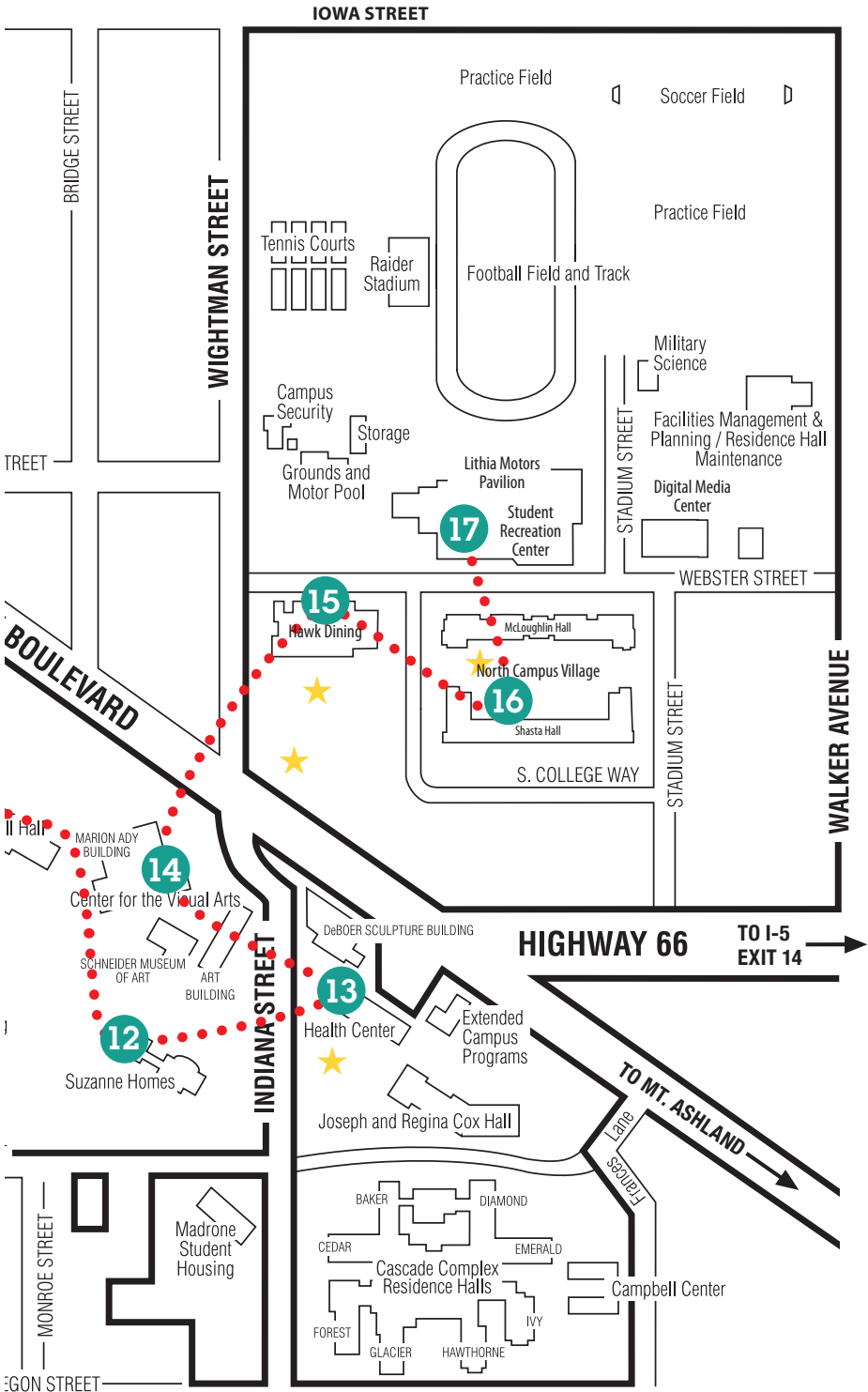

IOWA STREET

BRIDGE STREET

WIGHTMAN STREET

TREET

BOULEVARD

WALKER AVENUE

WEBSTER STREET

STADIUM STREET

STADIUM STREET

HIGHWAY 66

TO I-5
EXIT 14

TO MT. ASHLAND

WAGON STREET

MONROE STREET

INDIANA STREET

Practice Field

Soccer Field

Practice Field

Football Field and Track

Raider Stadium

Tennis Courts

Military Science

Facilities Management & Planning / Residence Hall Maintenance

Digital Media Center

Campus Security

Storage

Grounds and Motor Pool

Lithia Motors Pavilion

Student Recreation Center

17

North Campus Village

16

McLoughlin Hall

Shasta Hall

S. COLLEGE WAY

Hawk Dining

15

Center for the Visual Arts

14

Suzanne Homes

12

DeBOER SCULPTURE BUILDING

Health Center

Extended Campus Programs

Joseph and Regina Cox Hall

BAKER

DIAMOND

CEDAR

EMERALD

FOREST

GLACIER

HAWTHORNE

IVY

Campbell Center

Madrone Student Housing



11. Churchill Hall

Churchill Hall is home to the offices of the President and senior university staff, as well as classroom space for the OHSU Nursing Program. Constructed in 1926 with an Italianate Revival design, it is the oldest building on campus.



12. Susanne Homes Hall

“Suzy” holds the offices for the SOU Service Center, the Honors College, and McNair Scholars



Campus Activity Installation

DISC GOLF COURSE

Located behind Susanne Homes and the Siskiyou Arboretum, the 9-hole disc golf course is free to students as well as the public. The course was funded by the Mathias family, SOU groups, and local businesses.



13. Student Health and Wellness Center

The center provides access to a wide range of health services including primary medical care, mental health care, preventative services, and campus-wide health promotion. All SOU students taking 4 or more on-campus credits are eligible for services at SHWC.



Campus Art Installations

AMERICAN PASTORAL

This installation by Adam Bateman is an investigation of the sculptural qualities of the irrigation systems used in the American West—it explores Modernist form and material in an agricultural context.



Campus Art Installations

MARY CAMPAGNA GARDEN

Acting as a surrealist natural and artistic pathway - the garden highlights American Pastoral with 2 permanent sculptures, *Bronze Arch II* and *Rodica* (pictured) and one slot for rotating student art.



14. Schneider Museum of Art and the Center for Visual Arts

The Schneider Museum of Art exhibits contemporary art free-of-charge to students and the public. Adjacent to Schneider is the Center for Visual Arts, comprised of Art departmental offices and classrooms, student and faculty galleries, a ceramics lab, and private 24-hour access art studios.



Campus Art Installations

FEATHER OARS

Built with wooden oars, this installation piece is representative of a float down the local Rogue River. As a functional piece of art, the bottom of the sculpture is used as seating which is constructed from recycled raft material and rotates around the central support.



15. The Hawk Dining Commons

As the main dining facility on campus, The Hawk has eight made-to-order food stations, the dining office, and a student convenience store, The Landing. Students can purchase meal plans of varying size depending on how many meals they plan to eat on campus.



Campus Art Installations

CONFLUENCE

Located in the courtyard of Raider Village, this is one of the newest installments on the SOU campus. With a bench and turf grass, this installation is designed to be a community area for residents of the housing complexes as well as a potential performance venue.



16. Raider Village

The Raider Village residence complex includes Shasta Hall, McLoughlin Hall, and The Hawk Dining Commons. The area between Shasta and McLoughlin acts as an outdoor social hub where students meet up to relax or enjoy games and events. SOU offers alternative housing options (not shown on this tour path). The Madrone Apartments are for independent students with 45 or more credits, or are 21 and up. Student Apartments & Family Housing is an affordable apartment and townhouse complex for students with families.



17. Lithia Motors Pavilion, Student Recreation Center and Raider Stadium

Opened in spring 2018, Lithia Motors Pavilion holds the Health and Physical Education department offices and classrooms, and the Raider athletic offices. Raider Stadium is conveniently adjacent to the pavilion.

The Student Recreation Center includes state-of-the-art fitness equipment for student use, an open gym with elevated indoor track, group classes, a 44-foot rock climbing wall (the tallest available between Eugene, Oregon, and Sacramento, California), an Esports lounge, and is home to the Outdoor Program.

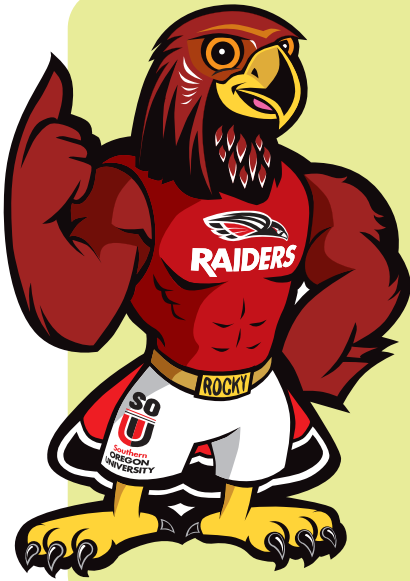

*We hope you've enjoyed your tour!
Here's a list of additional campus resources you might find useful.*



CAMPUS RESOURCES

Academic Advising
sou.edu/advising

Bookstore
sou.edu/bookstore

Campus Public Safety
sou.edu/security

Career Connections
sou.edu/careers

Collegiate Recovery Program
sou.edu/core

Dean of Student
dos.sou.edu

Disability Resources
sou.edu/dr

Financial Aid
sou.edu/finaid

Housing
sou.edu/housing

Parking Services
sou.edu/parking

Student Life
sou.edu/studentlife

Outdoor Program
sou.edu/outdoorprogram

Raider Student Services
sou.edu/student-services

Social Justice & Equity Center
sou.edu/sjec

SOU Mentor Program
sou.edu/mentor

Student Health & Wellness Center
sou.edu/health

TRiO, Success at Southern
sou.edu/success

OTHER RESOURCES

Ashland Information
www.ashlandchamber.com

Public Transportation
RVTD.org



Office of Admissions

1250 Siskiyou Boulevard • Ashland, Oregon 97520

541-552-6411 (local) • 855-470-3377 (toll free)

admissions@sou.edu • sou.edu/admissions

SOU IS SOCIAL!

Find SOUAdmissions on



Find SouthernOregonUniv on



SOU 360°

sou.edu/#virtualltour